

Allegro Console Installation Book



Installation Instructions and Operation Manual Effective 2021

Installer: This booklet must be given to the product owner.

Please note important information below:

Distributor Name & Location: _____

Model Number: _____

Date of Purchase: _____



Owner's Manual and Installation Guide

Thank you for choosing a Hastings Allegro Console. You have purchased a product designed and manufactured in Italy. We know it will give you many years of pleasure. The instructions in this booklet will provide you with the information you need to install and operate this unit. This information is also available online at www.hastingstilebath.com. Our customer service department is available to answer any additional questions you may have relating to the installation and operation of your Vanity. Call 800-351-0038 to speak to our Customer Service representative. Please have your model number and order information available when calling.

Important Safety Instructions

Warning: When using this product, basic precautions should be followed as noted below:

This manual contains information and instructions for proper operation and maintenance of your Hastings Vanity. Failure to follow these instructions could result in personal injury.

Read and Follow All Instructions

Instructions Regarding Risk of Personal Injury

- ▶ Do not permit children to use this unit unless they are closely supervised by an adult at all times.
- ▶ Use this unit only for its intended use as described in this manual. Do not use attachments not authorized by the manufacturer.

DANGER: To reduce the risk of injury, never sit or stand on the vanity or shelf..

INSTALLER/OWNER BEARS ALL RESPONSIBILITY TO COMPLY WITH ALL STATE AND LOCAL CODES WHEN INSTALLING THIS PRODUCT

Caution: Do not use harsh abrasives or solvents for cleaning this unit.

- ▶ This product is intended for residential indoor use only. It is only warranted for indoor installation in a climate controlled environment.
- ▶ Do not store at temperatures below 32 degrees Fahrenheit.



SAVE THESE INSTRUCTIONS

Unpacking the Unit

1. Inspect the Carton.
2. If you note carton damage, take a picture, note the delivery receipt as damaged and contact the dealer or Hastings immediately. **Do not install a damaged product. Hastings is not responsible for damage during transit.**
3. Immediately inspect the unit for damage even if there is no visible carton damage and immediately report any damage to the distributor or manufacturer customer service at 1-800-351-0038. Once the unit is installed and there is surface damage visible, we will assume it was caused by the installer. Installers are responsible for damage that occurs once the unit is set in place. Installation constitutes acceptance.
4. Remove all packaging material except for the protective foam covering. The protective foam covering was put on the product to help eliminate abrasions due to handling and should not be removed until you are ready to inspect or just prior to installation.

Installation and Operation Guidelines

Read all instructions before installing the product. Installer/product owner is responsible for complying with all state and local codes. Hastings strongly recommends using licensed professionals to install these products. **Warning: Certain cleaning products will permanently damage the cosmetic surface of the product. Read cleaning product instruction carefully before using. Never use anything abrasive, aerosol sprays, or metal scrapers.**

BEFORE INSTALLING:

Remove the protective plastic and inspect the product thoroughly. The protective plastic was put on the product to help prevent abrasions/staining, and the cosmetic surface of the product should be protected in some manner after the protective plastic is removed. A factory defect must be reported to the manufacturer before the product is installed. Defects or damage claimed after installation will be excluded from the warranty.

ATTENTION INSTALLER!

Important: Measure the product on site carefully. Hastings is NOT responsible for any preparatory labor or materials.

Warning: Some Vanities and tops may be very heavy. Make sure you have adequate help to move/install them before beginning. Hastings is not responsible for handling damage.

Always protect the product from construction damage. Damage, including chips and scratches, incurred at the jobsite is excluded from the warranty, but may be repaired by a qualified individual at the owner's expense.

Important:

Installation Planning and Preparation

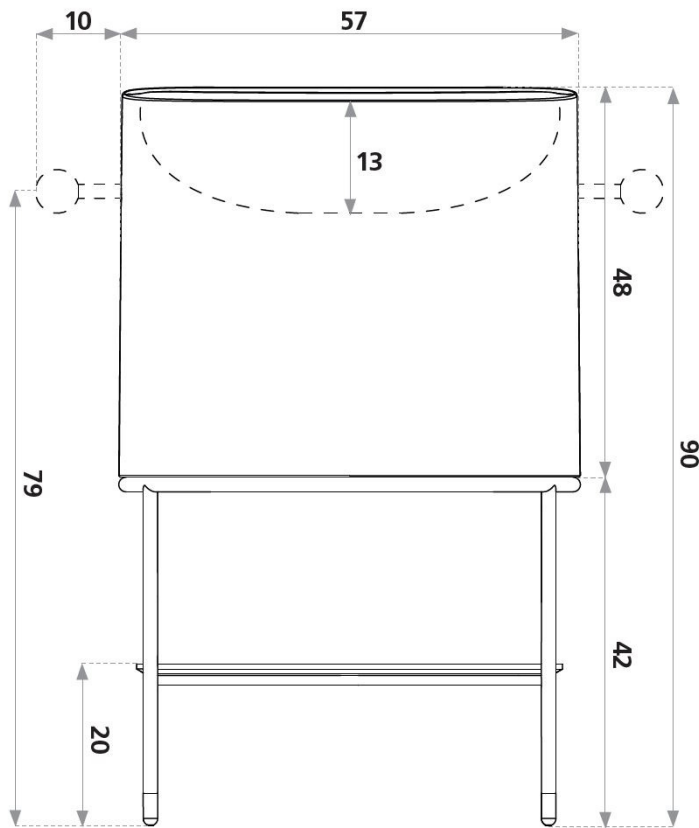

**To convert sizes to
inches, divide by
2.54**

Installer to provide Blocking
to support the vanity and top or
drawer system.
Use typical installation methods

Typical tools needed provided by installer

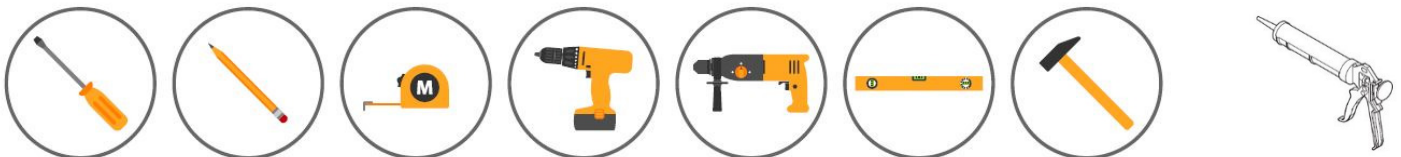

- *Rough plumbing and product size details can be found on the product Spec sheet.*

**To convert sizes to
inches, divide by
2.54**

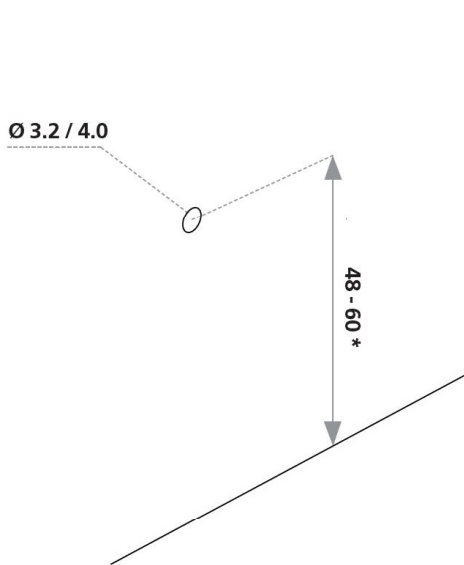

***(A)** _Consigliato 50
_Recommended 50
_Empfohlen 50
_Conseillé 50

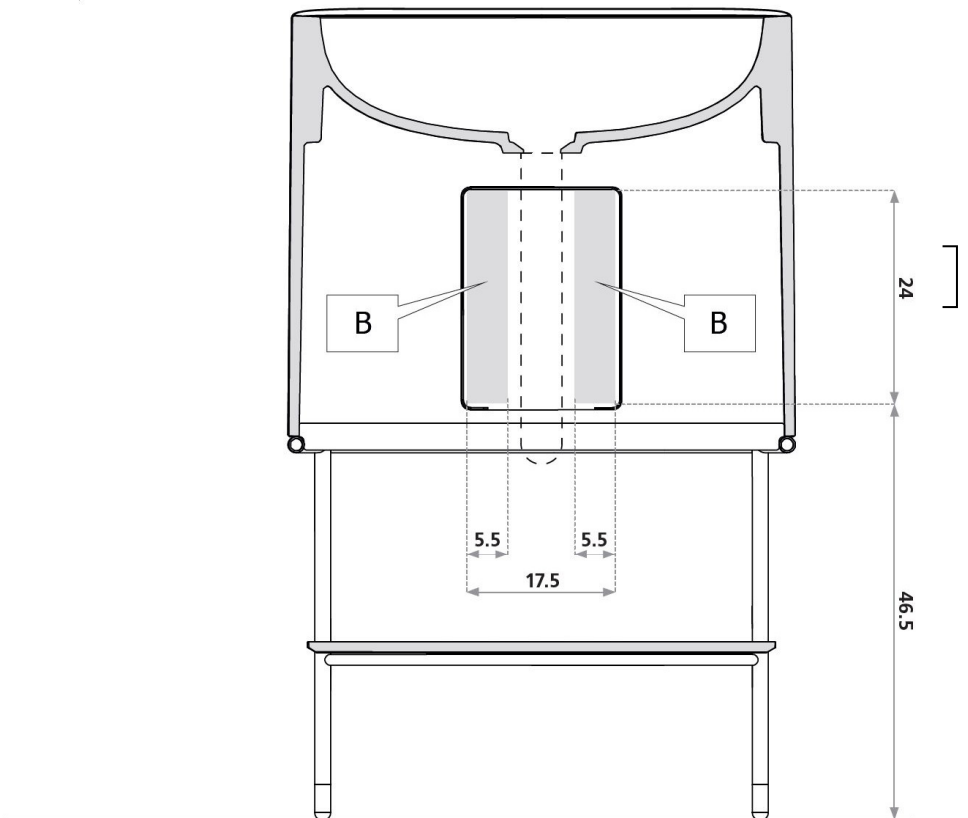

Items included

- 1- Sink
- 2- Legstand support
- 3- Shelf

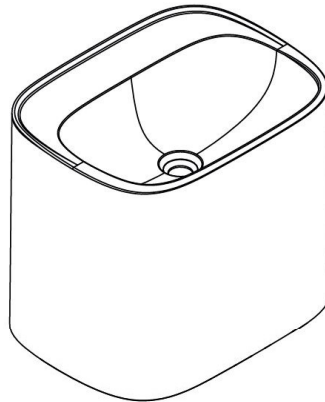

1

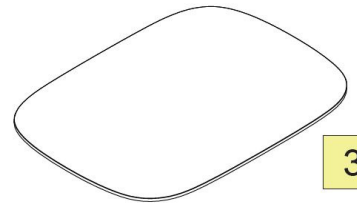

3

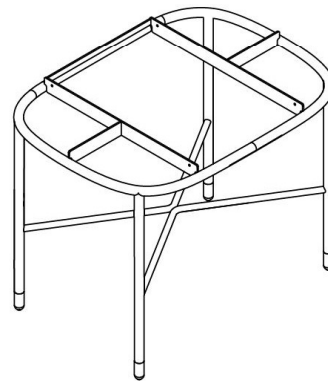

2

Items included

- 5- P Trap assembly
- 4- Drain

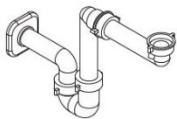

5



4

Optional items

- 6- Towel Holder
- 7- Trap Shroud

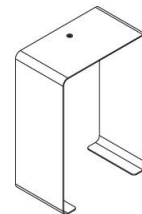

7

(OPTIONAL)

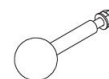

6

(OPTIONAL)

_1

_optional
_optional
_optional
_optionnel

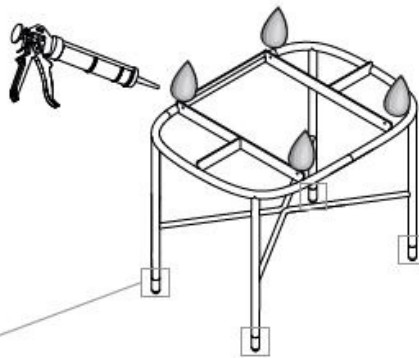
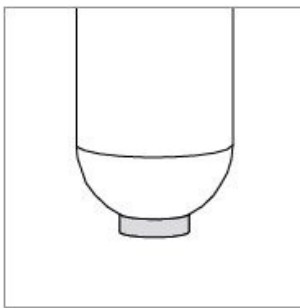
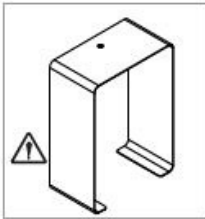

Place the legs near the point of installation. Place clear silicone on the point's shown.

Using 2 or more persons place the sink basin on to the legs.

If using the options siphon cover refer to page 10 for instructions

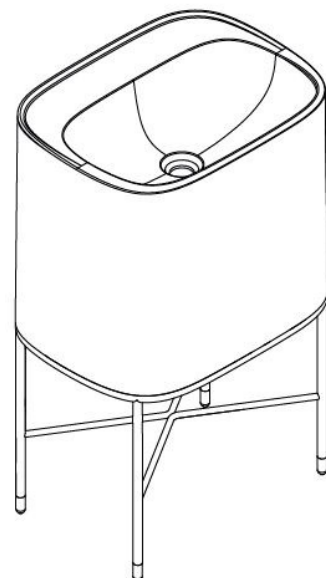
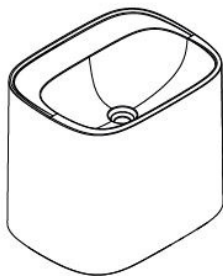
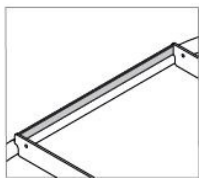



HASTINGS
TILE & BATH

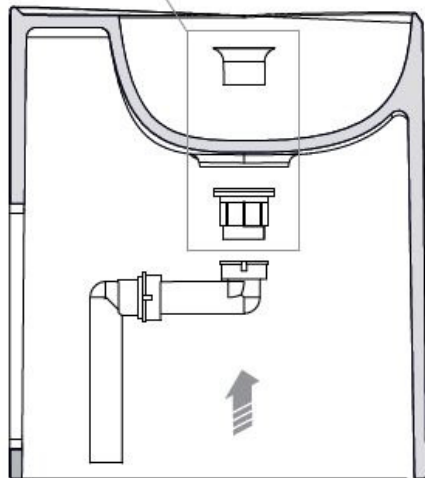
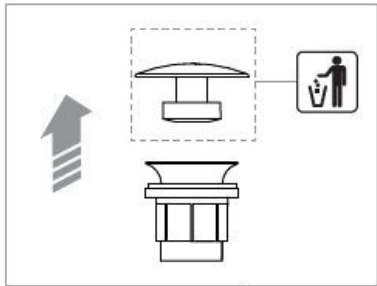

If a deck mounted Faucet is being used It is recommended to install the faucet onto the countertop at this time for ease or reaching the connections.

Install the Plumbing and drain using standard plumbing practices. Note: It is recommended to use clear silicone as your drain seal as plumbers' putty may stain the matte solid surface tops.

IMPORTANT NOTE:
STOP HERE if using
Optional Towel Holders
and go to page 12
For Instructions

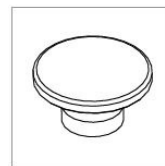

Color matched drain cover is provided.

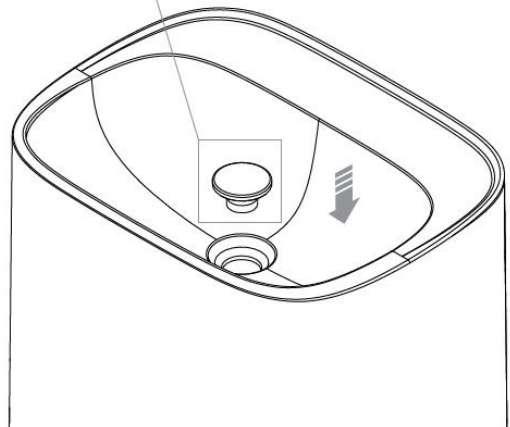

Check to make sure the wall is flat with no belly or wave in the wall material. All wall material should be flat and permanently bonded.

- Position the console in the desired location with the center of the sink aligned with the drain location on the wall..
- Be sure to lift by the legs to move into position, do not drag into place. Two persons are needed
- Place small amount of silicone on the back of the sink, do not over do as it may become difficult to move the sink if needed.
- Attach the plumbing using standard plumbing practices.

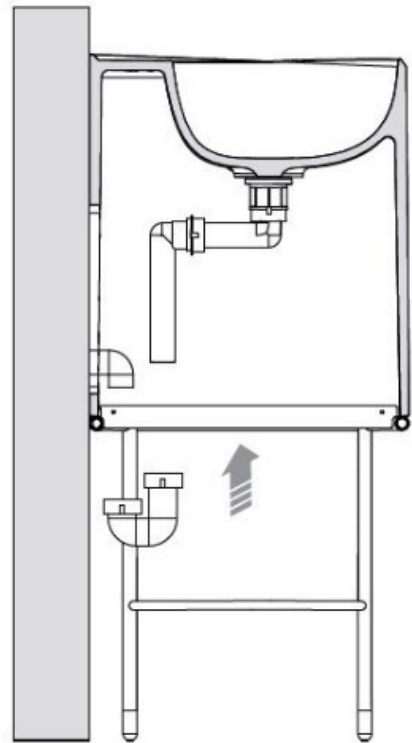
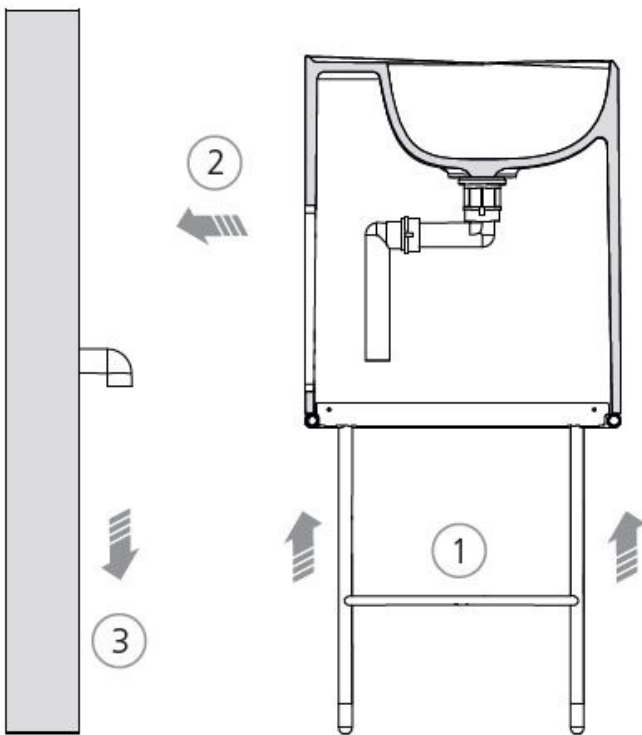



HASTINGS
TILE & BATH

OPTIONAL

- Siphon Cover.
- For tile or stone walls, a hammer drill and masonry drill bit may be needed

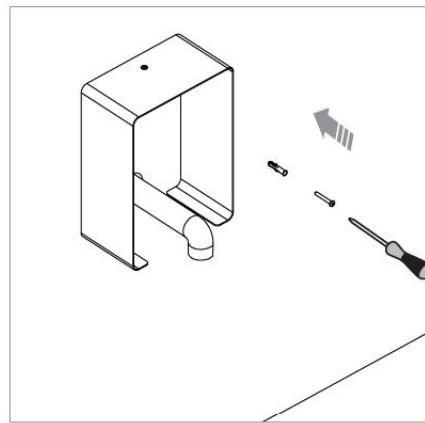
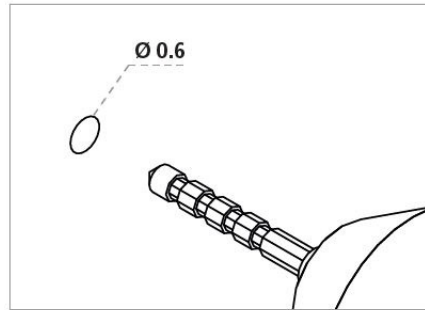
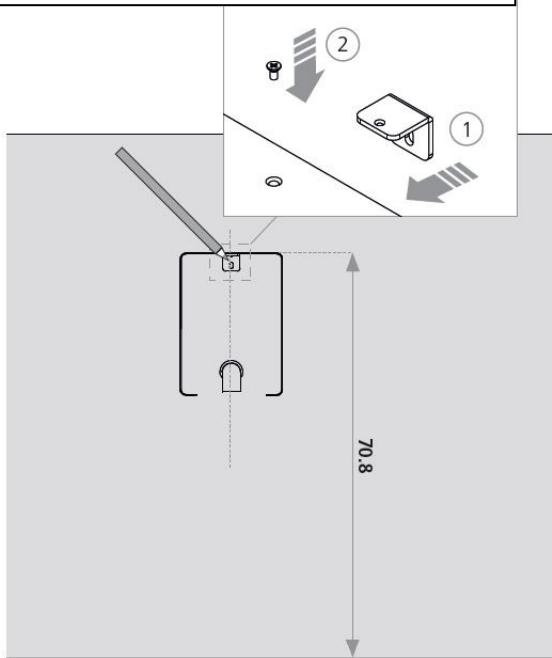

When moving into the final position be sure to lift and move, do not drag.

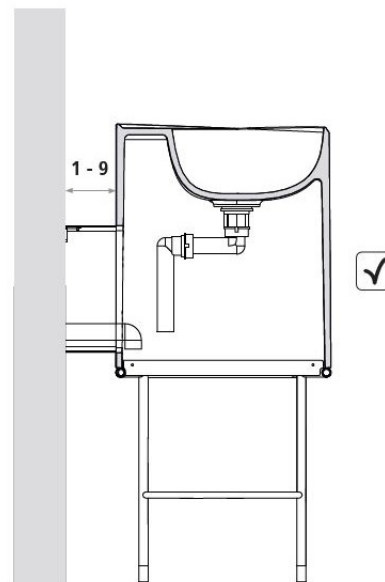
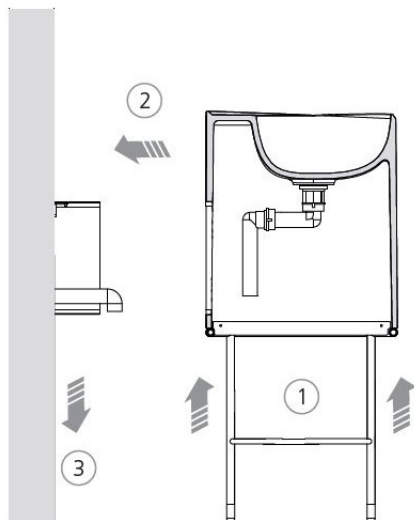



HASTINGS
TILE & BATH

Installing the Shelf

- Place the 4 supports F01 in place as shown, apply a small dab of silicone.
- Lower the shelf in place and push into the supports F01

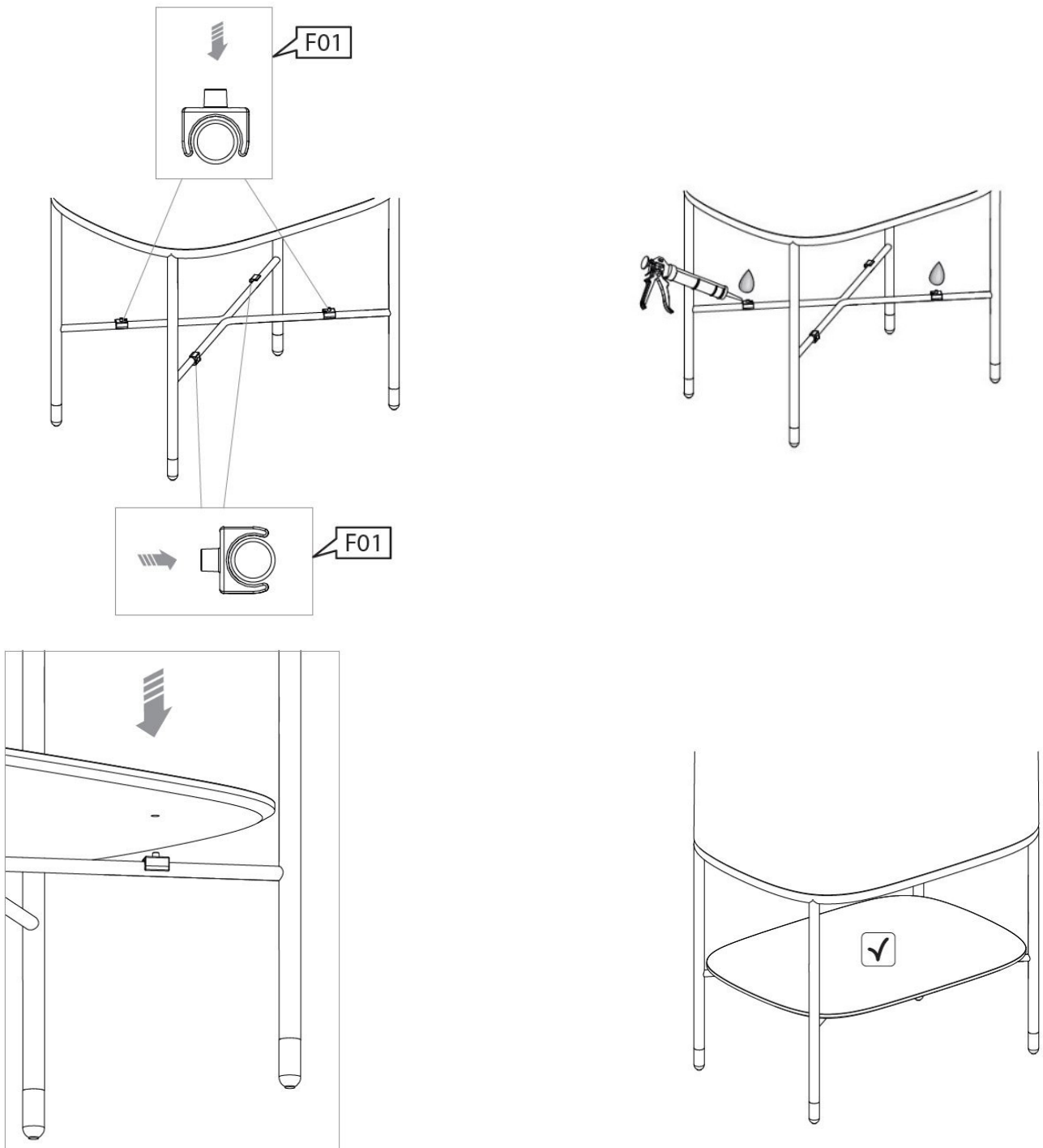

Installing the Optional Towel Holders

- Holes must be drilled in advance at the Factory
- Left of Right or both can be specified in advance at time of ordering
- Simply place the Towel Holder into the hole and attach the nuts and washers as shown from inside

⇒destro ⇒right
⇒rechts ⇒droite

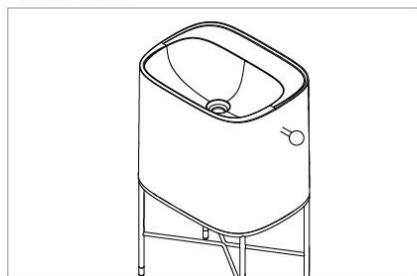

⇒sinistro ⇒left
⇒links ⇒gauche

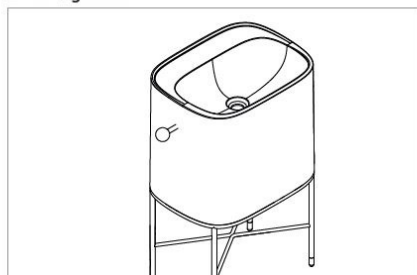

⇒destro + sinistro ⇒right + left
⇒rechts + links ⇒droite + gauche

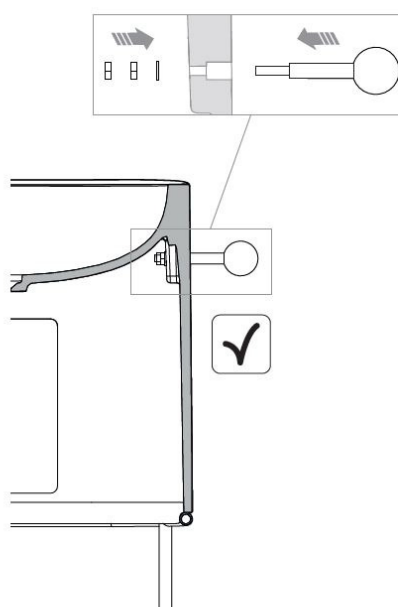
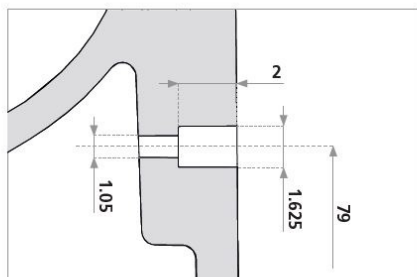
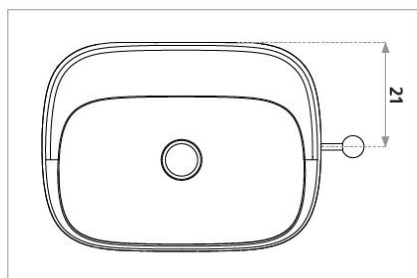
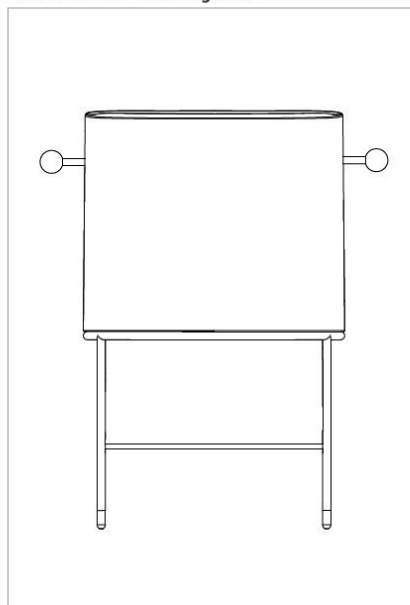

Care and Maintenance

INSTRUCTIONS FOR CARE AND MAINTENANCE - We do recommend to proceed as in the following instructions for care and maintenance of the product:

- For the daily cleaning use only non abrasive products suitable to the bathroom cleaning applying them with a soft cloth.
- Eventual spots more persistent can be removed with use of product type "Viakal vinaigre".
- Tecnoblu is shock Resistant and the typology of surface may not show possible little stripes. However, in case of evident stripes, it is possible to operate with the use of bodywork polishing products (polish or beeswax) available in hobbies shops, applying them with a soft cloth and with circular movement.

Attention not to use cleaning solvent (e.g. white spirit, acetone, etc.) varnish removers, oven cleaning products and for metal cleaning. In case of accidental contact with these products rinse-off immediately with running water, then, in case of matted surface proceed as specified before.

MAIN CHARACTERISTICS OF THE MATERIALS -

- Washbasin in Tecnoblu textured material Trendy covered in Gelcoat. Resistant to temperature changes at high levels, UV rays and stains. It is antibacterial and has good resistance to shocks (traction and bending).
- Standard tray in smooth Tecnoblu coated in Gelcoat.
- The edge and the inside of the washbasin are smooth and matching.
- Flush and matching thread cover in smooth Tecnoblu covered in Gelcoat.
- Alublack metal frame and brass-plated feet.
- Alublack metal carter.
- Alublack metal towel rack with brass-plated knob.

CLEANABILITY - The surfaces are opaque, non absorbing and without inaccessible corners that compromise the ease of cleaning.

DURABILITY - Guaranteed since they comply with the following requisites:

- Stability of the bottom.
- Resistant to changes of temperature.



LIMITED WARRANTY

All Hastings Allegro Consoles are warranted in accordance with the following Limited Warranty:

Hastings Allegro Consoles are warranted against defects in material and workmanship from the date of the first consumer purchase.

The Allegro Console manufacturer warranty is 3 year against defects. This Warranty shall apply to defective surfaces which crack, fade or blister.

The Warranty extends to the first consumer purchaser and not to subsequent owners, transferees or users other than the first purchaser. This warranty does not extend to products previously utilized as display models.

This Warranty shall apply to products installed and used only for indoor personal, family or household purposes and which are installed and maintained in accordance with Hastings recommended installation and maintenance procedures. This Warranty does not extend to defects or damage caused, in whole or in part, by any unauthorized or unreasonable use such as misuse, abuse, negligence or accidental damages resulting from customer or installer. No liability shall exist for incidental or consequential damages caused in whole or part by any defects in Hastings products. No warranty, expressed or implied, including any warranty of merchantability or fitness for a particular purpose, shall apply after the warranty period described above. Some states do not allow the exclusion or limitation of incidental or consequential damages or limitations on how long an implied warranty last. The above limitation may not apply to you.

In the event of a defect in material or workmanship of a Hastings Bath distributed product during the Warranty period, defective products will be repaired or replaced by Hastings, at its sole and absolute discretion. However, Hastings shall not be liable for the expense for removing defective products or installing replacement products. In certain circumstances, some states do not allow the limitation of liability for removal, transportation and reinstallation expenses. The above limitation may not apply to you.

Only Hastings is authorized to perform its warranty obligation. If you wish to obtain performance of the Hastings warranty obligation you should contact Hastings, telephone number 800-351-0038. Other information about performance of the Hastings warranty obligation may be obtained at the same address and telephone number.

This Warranty gives you specific legal rights and you may also have other rights which vary from state to state.

For Warranty claims contact Hastings tile and Bath;

711-8 Koehler avenue Ronkonkoma, NY 11779 - 1-800-351-0038 - email cs@hastingstilebath.com